

Installing the Intune Company Portal App - iPads

The Intune Company Portal app will support the BYOD program in the following methods:

- Install a security certificate on the device to allow for Wi-Fi and web filtering to work correctly in school.
- Allow relevant apps and software to be downloaded and signed into on the school account.
- Allow easy access to other key links

Please follow the steps below to install this on the BYOD laptop in preparation for use in school

Step 1 - Open the App Store and search for Intune Company Portal, then download the app

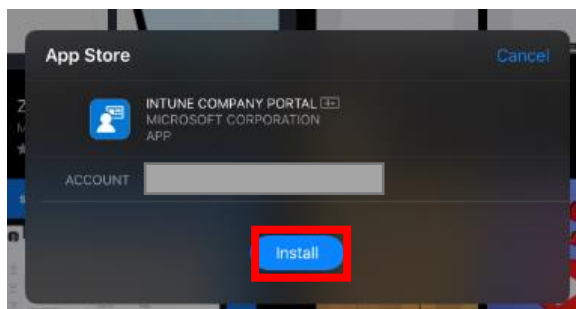
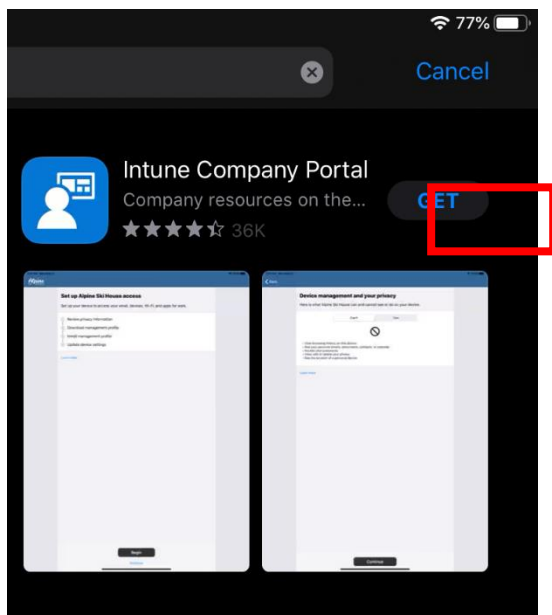
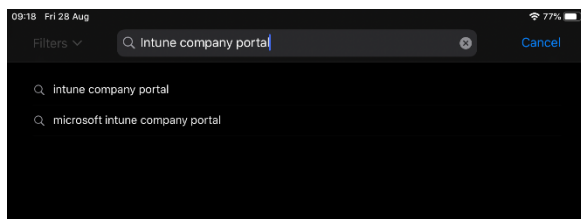

Step 2 – Open the app and click “Sign in”. Sign in using your Princethorpe email address and password.

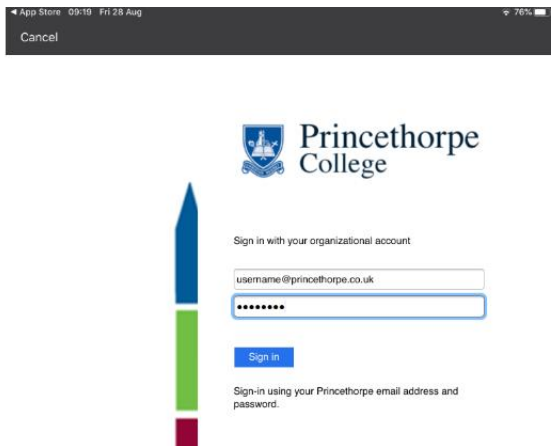

Step 3 – Click “Begin” to start setup of the device.

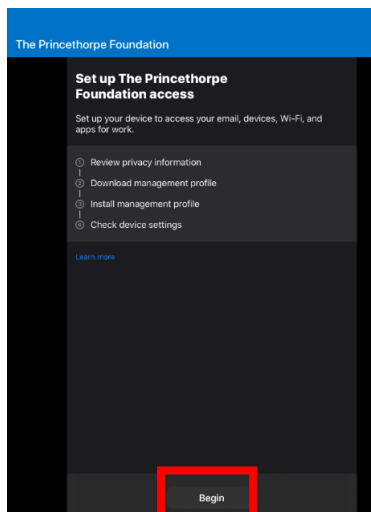

Step 4 – Read the privacy information, and if you agree click “Continue”.

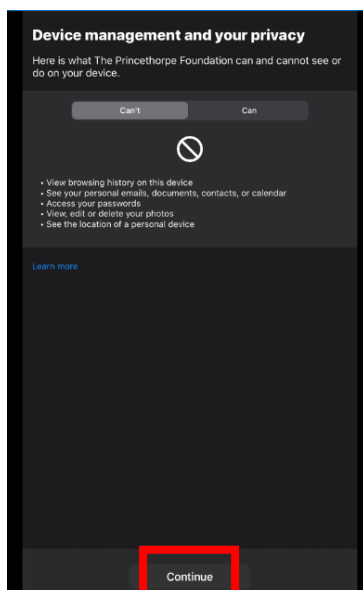

Step 5 – Click “Allow” on the popup asking if you want to allow a management profile to be downloaded.

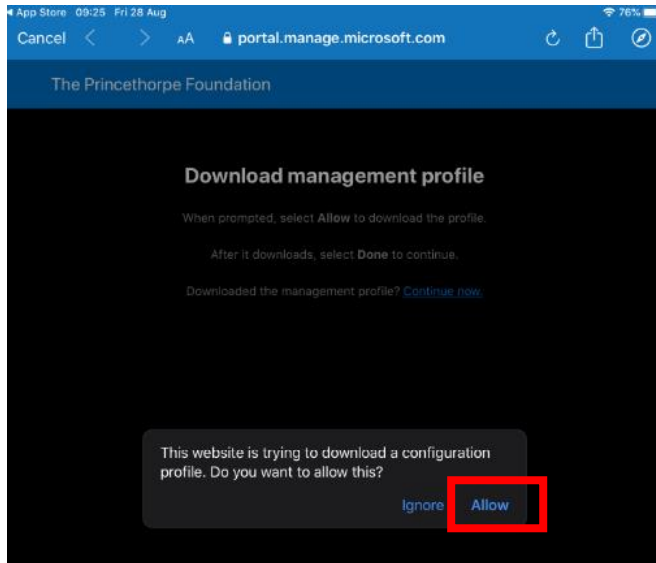

Step 6 – Close the confirmation popup and press “Continue now” and then “Continue”.

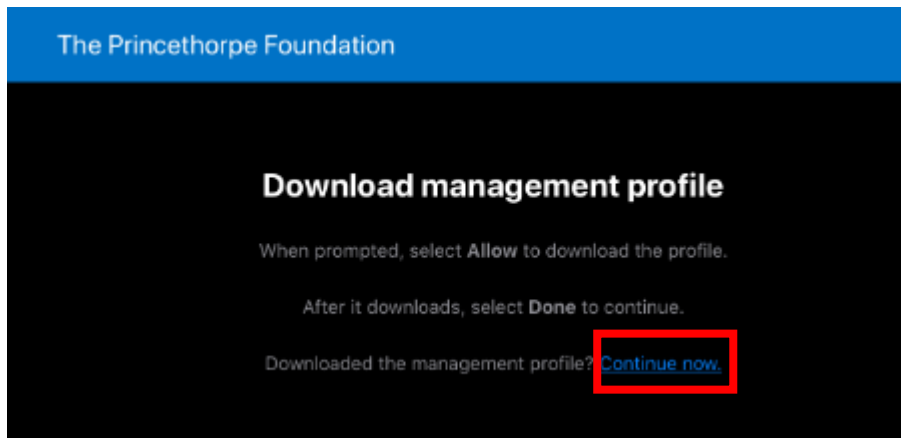
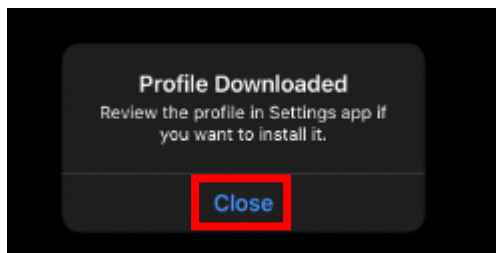

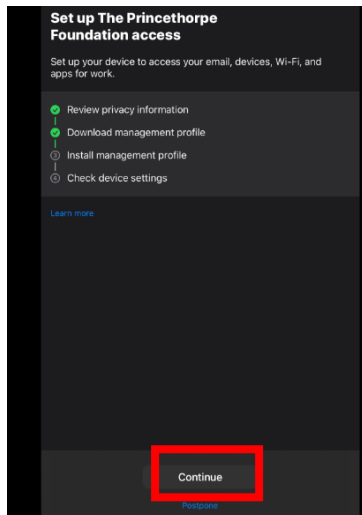

Step 7 – Follow the on screen instructions to install the management profile by going to the settings app, as in the screenshot below.

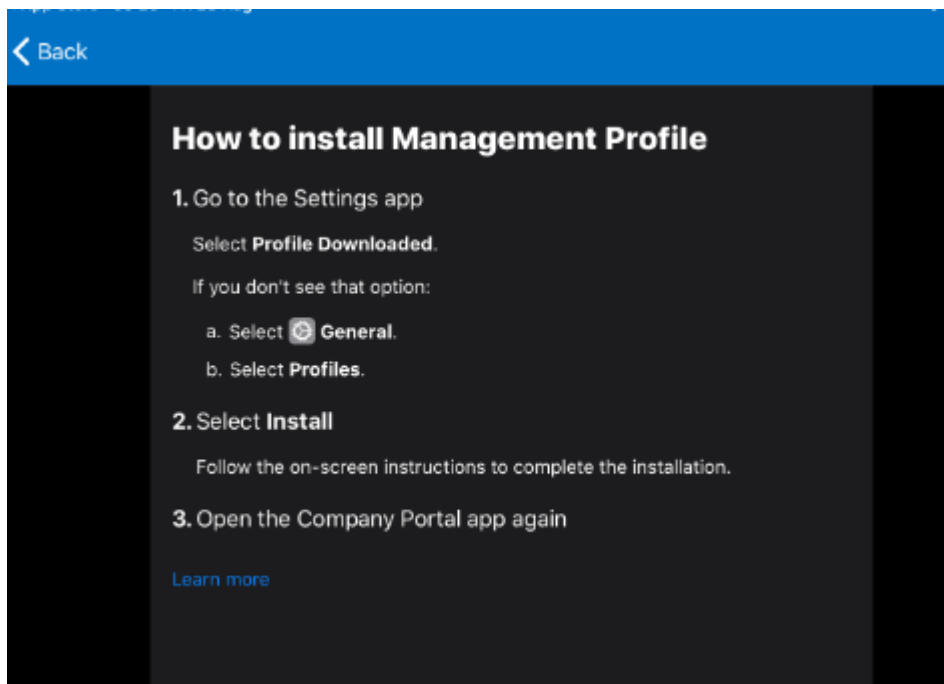

Step 6 – Return to the Company Portal app and click “Yes, I installed the profile”.

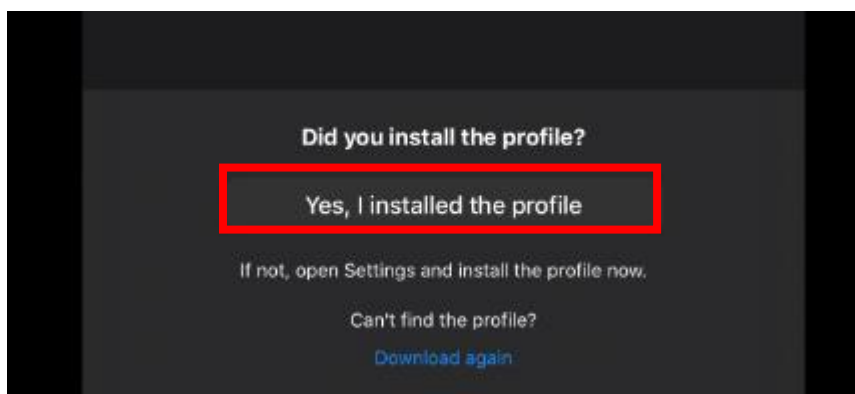

Once you have completed this, the apps will download in the background and begin to appear in the launcher. If they don't automatically download, please click on the app and then on "Install". The security certificate will also now be installed.

Once this is complete, the device is ready to use in school.

